

HOFFMANN, POLZIN & ASSOC., CONSULTANTS

Post Office Box 182
W246 S3145 Industrial Lane
Waukesha, Wisconsin 53186
414-542-0436

PLANNING
SURVEYING
ENGINEERING
ARCHITECTURE



PLAT OF SURVEY

FOR: Ralph Chapman

SCALE 1" = 40'

Lot 15 and the West One-Half of Lot 14, Freuck's Subdivision in the Northwest One-Quarter of Section 18, Town 4 North, Range 18 East, Town of East Troy, Walworth County, Wisconsin.

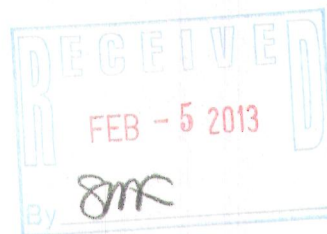

LAKE
BEULAH

⊙ INDICATES IRON PIPE SET
○ INDICATES IRON PIPE FOUND

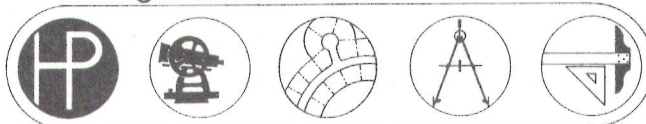

SURVEYING PLANNING ENGINEERING ARCHITECTURE

CERTIFICATION

"I HAVE SURVEYED THE ABOVE DESCRIBED PROPERTY, AND THE ABOVE MAP IS A TRUE REPRESENTATION THEREOF AND SHOWS THE SIZE AND LOCATION OF THE PROPERTY, ITS EXTERIOR BOUNDARIES, THE LOCATION AND DIMENSIONS OF ALL STRUCTURES THEREON, FENCES, APPARENT EASEMENTS AND ROADWAYS AND VISIBLE ENCROACHMENTS, IF ANY.

THIS SURVEY IS MADE FOR THE EXCLUSIVE USE OF THE PRESENT OWNERS OF THE PROPERTY, AND ALSO THOSE WHO PURCHASE, MORTGAGE, OR GUARANTEE THE TITLE THERE-TO, WITHIN ONE (1) YEAR FROM DATE HEREOF; AND AS TO THEM I HEREBY CERTIFY THAT SAID SURVEY AND THE ABOVE MAP WERE MADE IN ACCORDANCE WITH ACCEPTABLE PRO-FESSIONAL STANDARDS AND THAT THE INFORMATION CONTAINED THEREON IS, TO THE BEST OF MY KNOWLEDGE, INFORMATION AND BELIEF A TRUE AND ACCURATE REPRESENTATION THEREOF."

DATED AT WAUKESHA, THIS 12 DAY OF August, 19 77
Claude C. Johnson, Jr.

REGISTERED LAND SURVEYOR

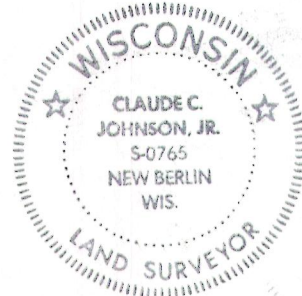

LAND SURVEYOR NO.

PFS-12A

DRAFTED BY Nan Thovattru

418-2337 JOB NO 1907 RC